

68020 MANUAL for ELECTROMECHANICAL LIMIT SWITCH - Revision 2

PRODUCT INFORMATION

Product full name: Electromechanical Limit Switch
 Product Group: 768100
 Nominal size: DN15-150
 Working temperature: -25°C to +70°C

PRODUCT DESCRIPTION

Product also contains a mounting bracket and 1-meter cable per switch.

IP67 degree of protection and ROHS compliant.

Electromechanical limit switch is used for remote position indication of quick closing valves, 1 pc for open or closed indication alternatively 2 pcs for open and closed indication.

The limit switch sends a signal either when contact is established or lost with an object. Contact is established through the square lever mounted on the limit switch head.

The electromechanical limit switch is mounted on a bracket that in turn is mounted on the valve. The brackets have different design depending on valve size, e.g. smaller sized brackets have a fork-design that requires two washers.

MOUNTING LIMIT SWITCH ON VALVE

ATTENTION! Before beginning the installation of the valve ensure that there is no media in the valve. If there is, make sure to drain the valve before continuing with the installation.

1. If not already, fully open the valve.
2. Choose two of the bolts attaching the bonnet to the valve body where you want to place the bracket. Loosen and remove the bolts completely.

If no suitable place for the bracket is available, the bonnet can be rotated to give better access: 1. With the valve in open position remove the bolts holding the bonnet. 2. Lift and turn the bonnet without damaging the gasket. 3. Re-assemble the bolts and tighten them. (see figure 1)

3. Valve size DN65 or smaller: Mount one washer on each bolt and re-assemble them so there is 3-4mm clearance between bolt with washer and bonnet.
4. Valve size DN65 or smaller: Fit the brackets “forks” (see figure 3) into the clearance and tighten the bolts.
5. Valve size DN80 or larger: Mount one bolt in each of the bolt holes (see figure 3) on the bracket. Re-assemble the bolts on the valve and tighten them.

ADJUSTMENT OF LIMIT SWITCH

A limit switch that is supposed to indicate an open state of the valve shall be positioned so that the square lever is above the indication washer. To indicate closed state the square lever shall be mounted underneath the indication washer.

Adjust the length and angle of the square lever by loosening it from the limit switch head. If needed dismount the square lever to bend it into a more advantageous shape.

Adjust the angle of the limit switch head by loosening the snap hatch.

Use a multimeter to make sure that the limit switch gives a signal at the correct position of the square lever.

It is possible to change the switch position on the bracket sideways by changing the holes it is mounted in on the bracket.

No.	Description
1	Contact house
2	Limit switch head
3	Square lever

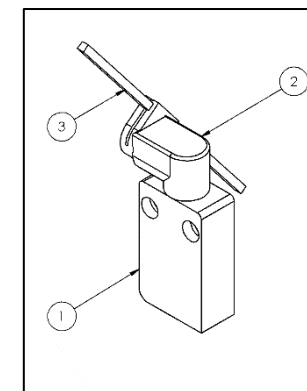

For more detailed information, please visit the Meson webpage or contact our company.

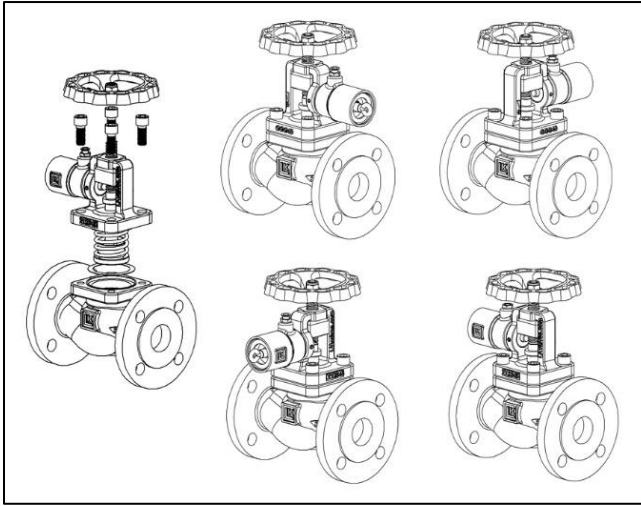

Figure 1 Turning bonnet.

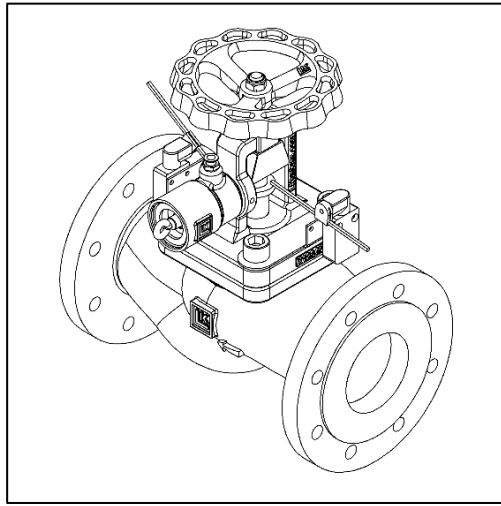

Figure 2 Electromechanical switches mounted on a QCV

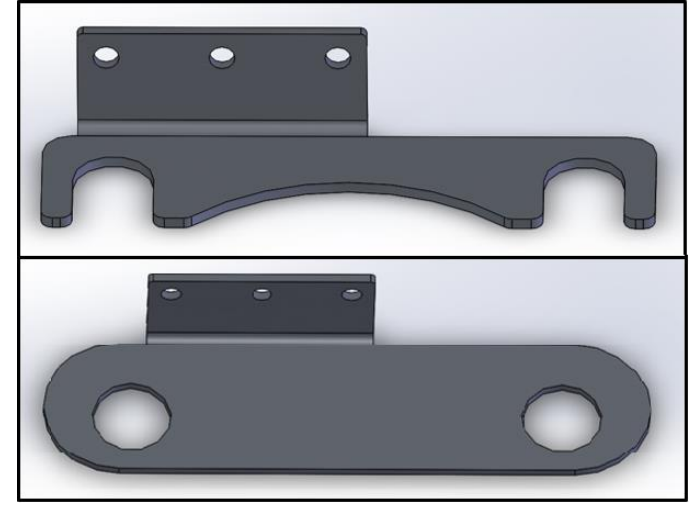

Figure 3 Bracket design for smaller DN-size with forks at the top and for larger sizes the design with bolt holes at the bottom.

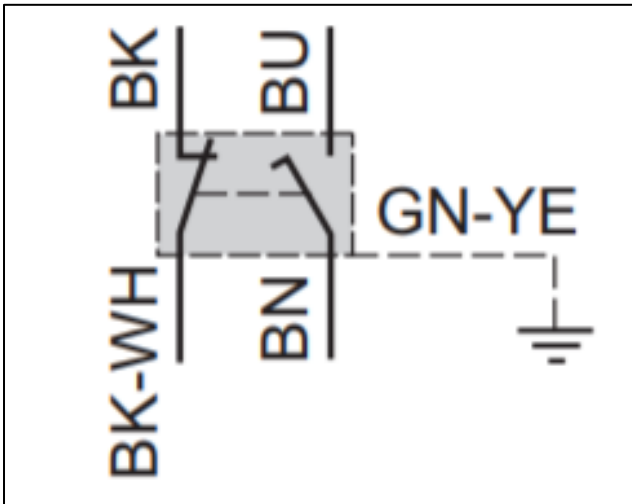

Figure 4 Wiring schema for electromechanical limit switch.

Code	Color
BK-WH	Black & white
BN	Brown
BK	Black
BU	Blue
GN-YE	Green & yellow